



PHOTO PERSONA SHORTCUTS





LIQUIFY PERSONA SHORTCUTS





DEVELOP PERSONA SHORTCUTS



ADVANCED TEXT

Press buttons for various actions
Alt ⌘ Cmd ⌘ Shift ⇧ Ctrl ⌘



⌘ + T Character Panel
⇧ ⌘ + T Typography Dialog

(Add ⌘ to increase step size ⬅️ & ➡️)
(Add ⇧ to decrease step size ⬆️ & ⬆️)

EXPRESSIONS

For use in input boxes in the Transform panel (and other areas of the UI)

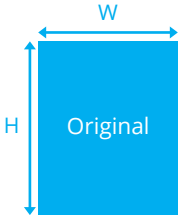

W: 120 px
H: 150 px

W:	118+55	=	173 px	W:	*=75%	=	90 px
W:	37*4	=	148 px	W:	h+30	=	180 px
W:	+=80	=	200 px	W:	h-5	=	145 px
W:	-=20	=	100 px	W:	2*h	=	300 px
W:	*=2	=	240 px	W:	h/2	=	75 px
W:	/=2	=	60 px	W:	gr*h	=	242.7 px
W:	*=1.4	=	168 px				

GESTURES

Zooming

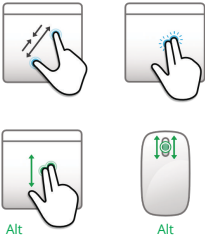



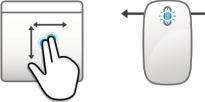

Panning

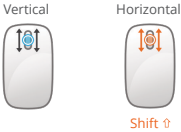

Scrolling



MODIFIERS & LAYER CONTROL

Clone, Healing & Liquify Mesh Clone	Option	Select a source	Painting	Shift Option + Drag Ctrl + Option + Drag	Draws straight line connecting two strokes Temporarily switches to the colour picker Left-right changes width, up-down changes hardness of brush
Dodge/Burn & Blur/Sharpen tools	Option	Temporarily switches to the opposite tool	Pixel selections	Shift Cmd Ctrl Option	Constrains marquee to square or circle Moves underlying layer with selection Adds to selection Removes from selection
Freehand Selection Tool	Shift Shift Drag	Temporarily switches to Polygonal from Freehand Temporarily switches between Polygonal and Magnetic Temporarily switches to Freehand from Polygonal or Magnetic	Pixel Tool	Cmd	Erases from the current layer or objects
General	Shift Cmd Option Ctrl	Reverses aspect ratio constraint on scaling Scales from the centre of selection Ignores snapping during operation Rotates from opposite corner of layer	Selecting	Shift Option Option + Drag Drag + Ctrl	Selects multiple layers Selects layer behind current selection Ignores initial layer below cursor Selects layers partially encompassed
Layers Panel	 Layer 1  Layer 1  Layer 1  Layer 1	Double-click = Change layer name Double-click = Zoom to layer Click + Option = Show selected only Click + Cmd = Pixel selection from layer	Vector drawing tools	Shift Option Cmd	Constrains node position and handle angles Sets node to Sharp (for creating cusps) Temporarily switches to Node editing (from Pen)
Liquify tools	Shift Option	Reduces rate of application of the effect Switches to the opposite of the default effect	White Balance Tool	Shift Option + Drag	Creates an average of multiple sampled points Creates a sample from a marquee
			Zoom Tool	Option + Click Option + Drag	Zooms out Zoom to marquee